



# IG-42

## Gearhead Motor Series (Planetary gear)

Gearbox with ball bearings  
 Gearbox with sleeve bearings



20%~85%RH      -10~+60  
 Operating relative humidity      Operating temperature range

### APPEARANCE SIZE

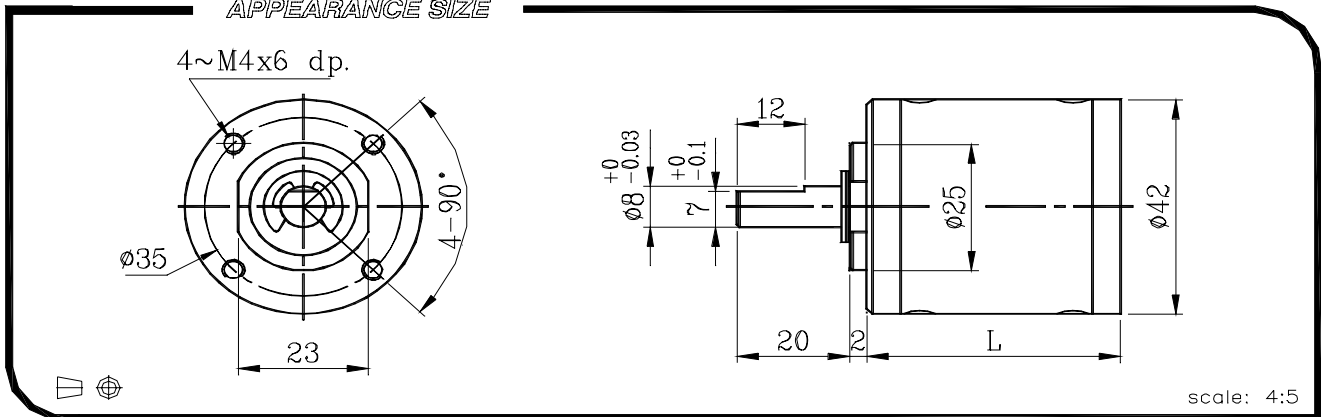

### PINION SPECIFICATIONS

Module	0.6			
No. of teeth	12	15	18	24
Pressure angle	20			
Hole diameter	ø3.98	ø4.98		
Reduction ratio	1/24, 1/84 1/104, 1/144 1/504, 1/864	1/720, 1/1062 1/1470, 1/2500 1/3000, 1/3600	1/17 1/61 1/212	1/14 1/49

### MOTOR INSTALLATION

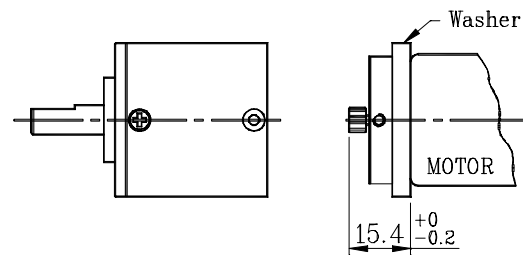

### GEARBOXES SPECIFICATIONS

Reduction ratio	Exact reduction ratio	Rated tolerance torque	Max momentary Tolerance torque	Efficiency	Radial play Of shaft	Thrusts play of shaft	L
1/4	4	5kgf - cm Max	15 kgf - cm	80%	0.05mm	0.3mm	32.5
1/14, 1/17, 1/24	14, 17 1/3, 24	10kgf - cm Max	30 kgf - cm	70%	39.2		
1/49, 1/61, 1/84	49, 60 2/3, 84	20kgf - cm Max	60 kgf - cm	60%	45.9		
1/104, 1/144	104, 144	20kgf - cm Max	60 kgf - cm	60%	45.9		
1/212, 1/294	212 1/3, 294	30kgf - cm Max	90 kgf - cm	50%	52.6		
1/504, 1/624	504, 624	30kgf - cm Max	90 kgf - cm	50%	52.6		
1/720, 1/864	720, 864	30kgf - cm Max	90 kgf - cm	50%	52.6		
1/1062	1061 2/3	30kgf - cm Max	90 kgf - cm	40%	59.3		
1/1470, 1/2500	1470, 2500	30kgf - cm Max	90 kgf - cm	40%	59.3		
1/3000, 1/3600	3000, 3600	30kgf - cm Max	90 kgf - cm	40%	59.3		